

M:\Client\Docs\Active\18-337 Bens Maple Headquarters Struct Design\Plans & Specs\200908 TEAM ENG PLAN-Bens Maple Syrup.rvt 11/16/2020 2:08:13 PM

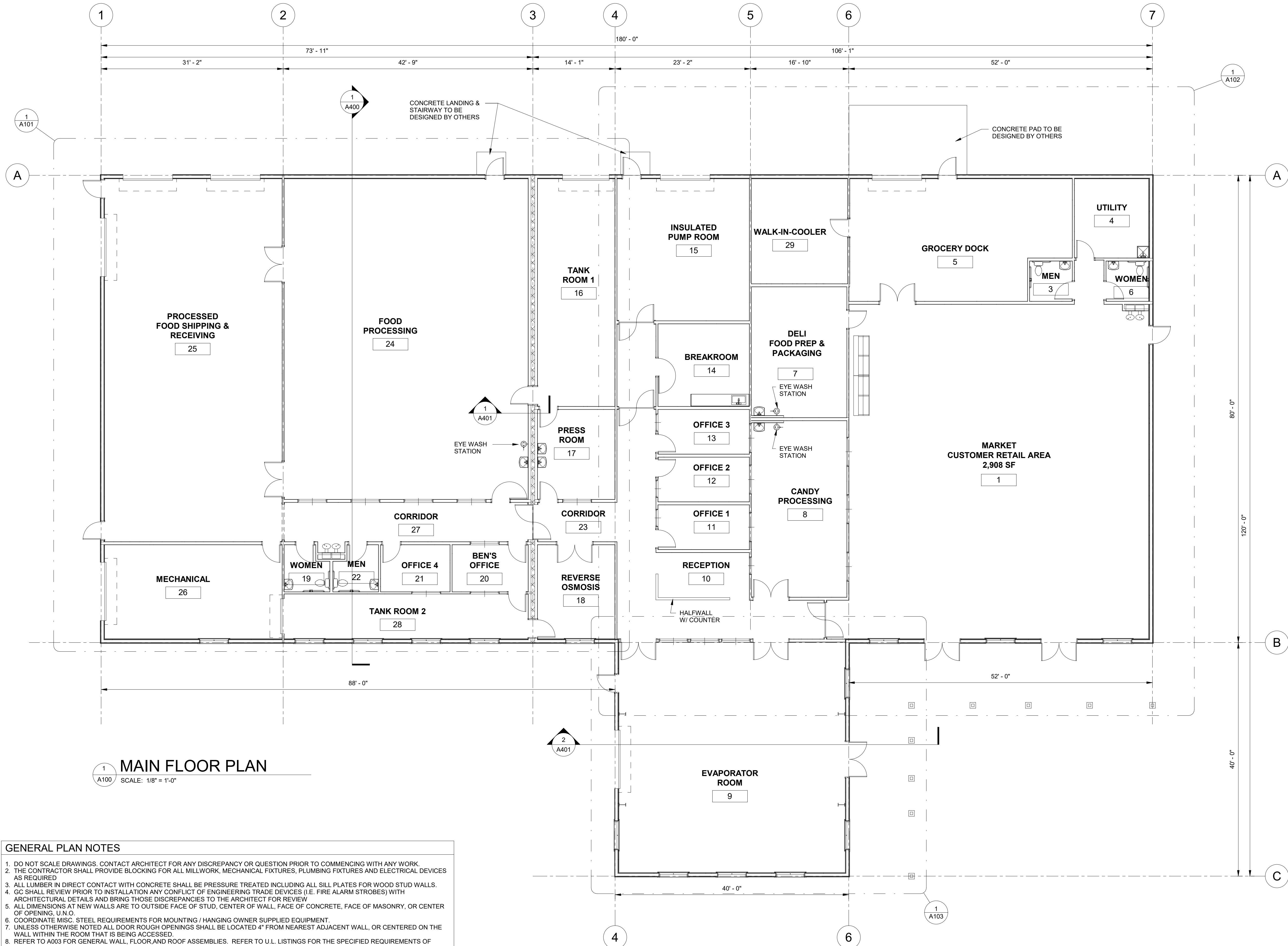

1
A100
MAIN FLOOR PLAN
SCALE: 1/8" = 1'-0"

- GENERAL PLAN NOTES**
- DO NOT SCALE DRAWINGS. CONTACT ARCHITECT FOR ANY DISCREPANCY OR QUESTION PRIOR TO COMMENCING WITH ANY WORK.
 - THE CONTRACTOR SHALL PROVIDE BLOCKING FOR ALL MILLWORK, MECHANICAL FIXTURES, PLUMBING FIXTURES AND ELECTRICAL DEVICES AS REQUIRED.
 - ALL LUMBER IN DIRECT CONTACT WITH CONCRETE SHALL BE PRESSURE TREATED INCLUDING ALL SILL PLATES FOR WOOD STUD WALLS.
 - GC SHALL REVIEW PRIOR TO INSTALLATION ANY CONFLICT OF ENGINEERING TRADE DEVICES (I.E. FIRE ALARM STROBES) WITH ARCHITECTURAL DETAILS AND BRING THOSE DISCREPANCIES TO THE ARCHITECT FOR REVIEW.
 - ALL DIMENSIONS AT NEW WALLS ARE TO OUTSIDE FACE OF STUD, CENTER OF WALL, FACE OF CONCRETE, FACE OF MASONRY, OR CENTER OF OPENING, U.N.O.
 - COORDINATE MISC. STEEL REQUIREMENTS FOR MOUNTING / HANGING OWNER SUPPLIED EQUIPMENT.
 - UNLESS OTHERWISE NOTED ALL DOOR ROUGH OPENINGS SHALL BE LOCATED 4" FROM NEAREST ADJACENT WALL, OR CENTERED ON THE WALL WITHIN THE ROOM THAT IS BEING ACCESSED.
 - REFER TO A003 FOR GENERAL WALL, FLOOR AND ROOF ASSEMBLIES. REFER TO U.L. LISTINGS FOR THE SPECIFIED REQUIREMENTS OF EACH ASSEMBLY AS WELL AS THE SPECIFIC REQUIREMENTS FOR PIPE AND DUCT PENETRATIONS. THE CONTRACTOR SHALL BE RESPONSIBLE FOR MEETING ALL U.L. REQUIREMENTS.
 - FIRE STOPPING AND/OR FIRE DAMPERS REQUIRED AT ALL PENETRATIONS THROUGH RATED WALLS AND/OR FLOOR/CEILING ASSEMBLIES.



TEAM ENGINEERING
82 Palomino Lane
Suite 503
Bedford, NH 03110-6448
Phone: (603) 497-3137
www.MyTeamEngineering.com

REVISION:	DATE:
APPROVAL	10/13/2020
REVISION	11/16/2020
REVISION	11/30/2020

- DRAFT
- APPROVAL
- BID
- PERMIT
- CONSTRUCTION

STAMP:
NOT FOR CONSTRUCTION

CLIENT:
Ben's Pure Maple Products, LLC

BENS MAPLE HEADQUARTERS
PROPERTY: Webster Highway
Temple, NH 03084
SHEET TITLE: **FLOOR PLAN**

A100
SHEET: 5 of 21
TE PROJECT NO.: 18-337
DWG: KA CHK: DDM