

Visuals for Ben's Pure Maple Products, LLC Proposed Sugarhouse and Market

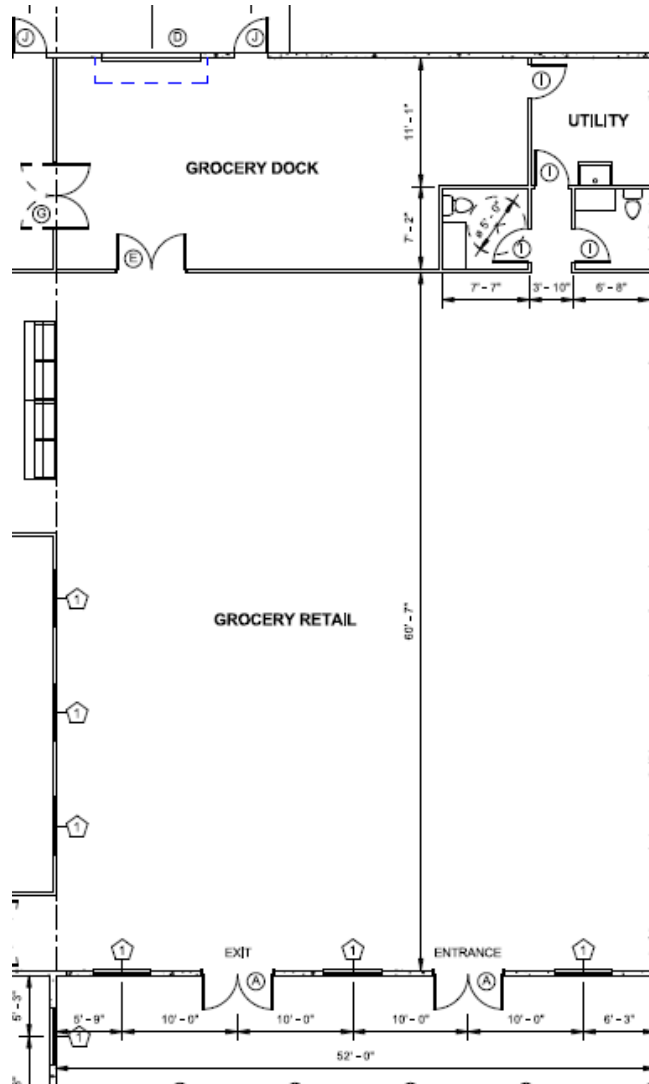

Floor Plan is not finalized and may be subject to change.
Seasonal displays will change but overall flow will
Stay as is below.



DELI CASE

GRAB N GO

LOCAL MEAT AND SEAFOOD

NUT MACHINE

Dry Goods & Gifts

Refrigeration and Freezers

SEASONAL DISPLAYS

MAPLE

CAFE TABLES

REGISTERS

BAKERY TABLES

PRODUCE

Exit

ENTRANCE

ENTRANCE VIEW

Upon entering the market customers can merge to the right where they will find fresh/local produce and also a variety of breads and baked goods on the display tables. Straight ahead is the “Mini Sugar-house” which will be the vocal point in the market. Maple syrup and other maple products will be displayed on the Inside and outside walls of the structure.



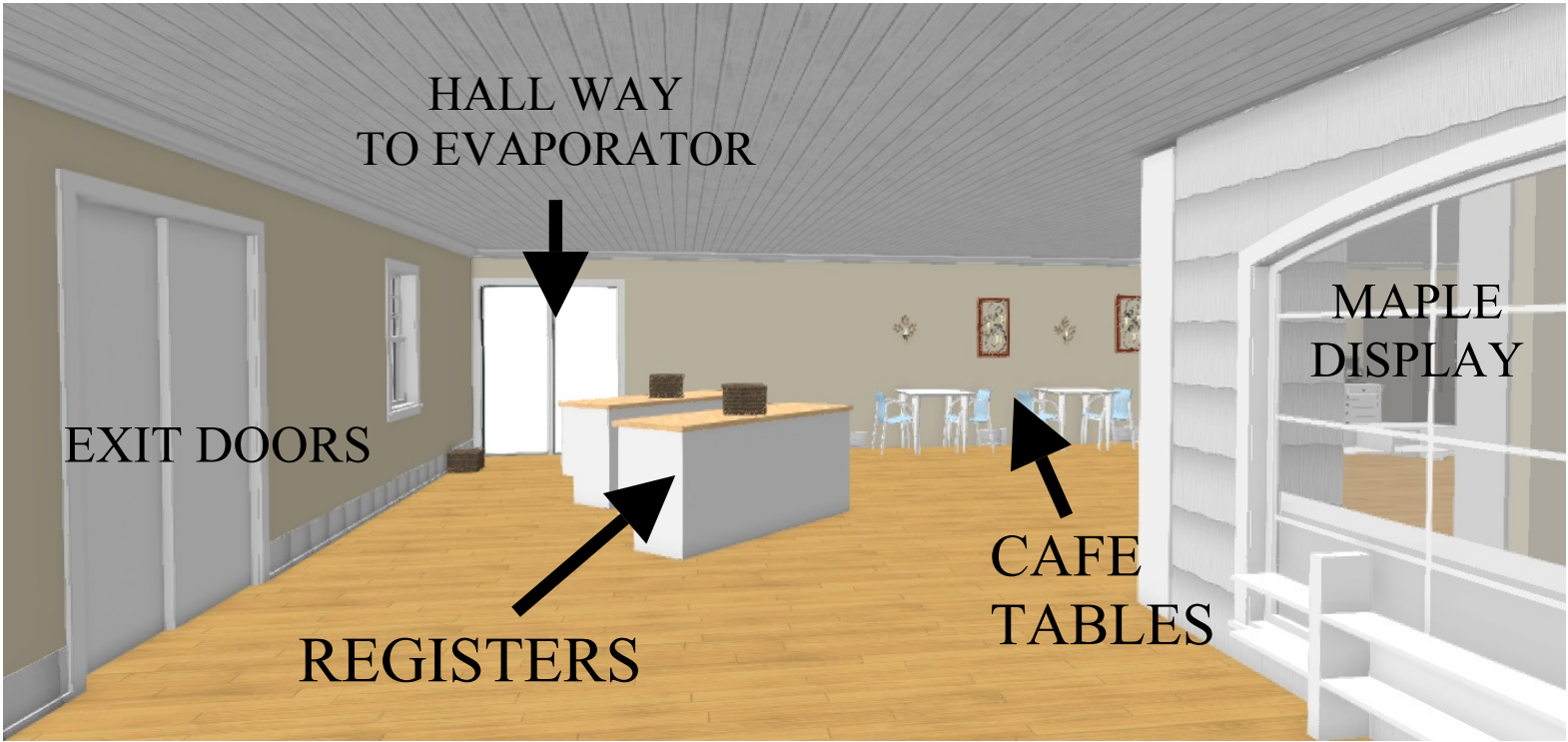

STORE FRONT

PRODUCE

FRONT
DOORS

BAKERY
DISPLAYS

SEASONAL DISPLAY

**The pictures used are simply to provide a visual reference, these pictures are not owned by Ben's Pure Maple Products, LLC.



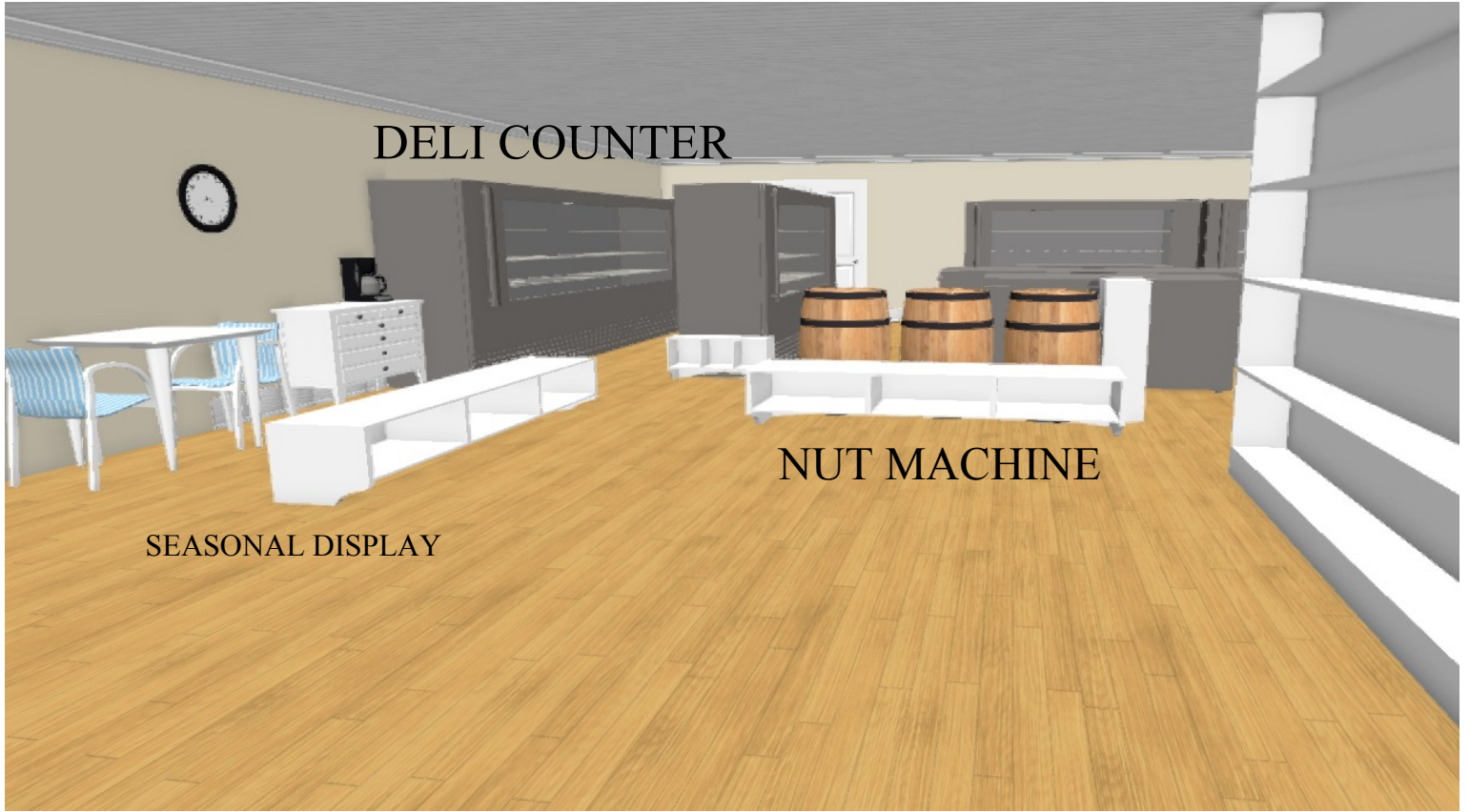

DELI COUNTER

SEASONAL DISPLAY

NUT MACHINE



NUTS

Almonds
Cashews
Pecans
Salted
Cashews

DELI COUNTER AND GRAB N GO



2-3 Small Cafe Tables



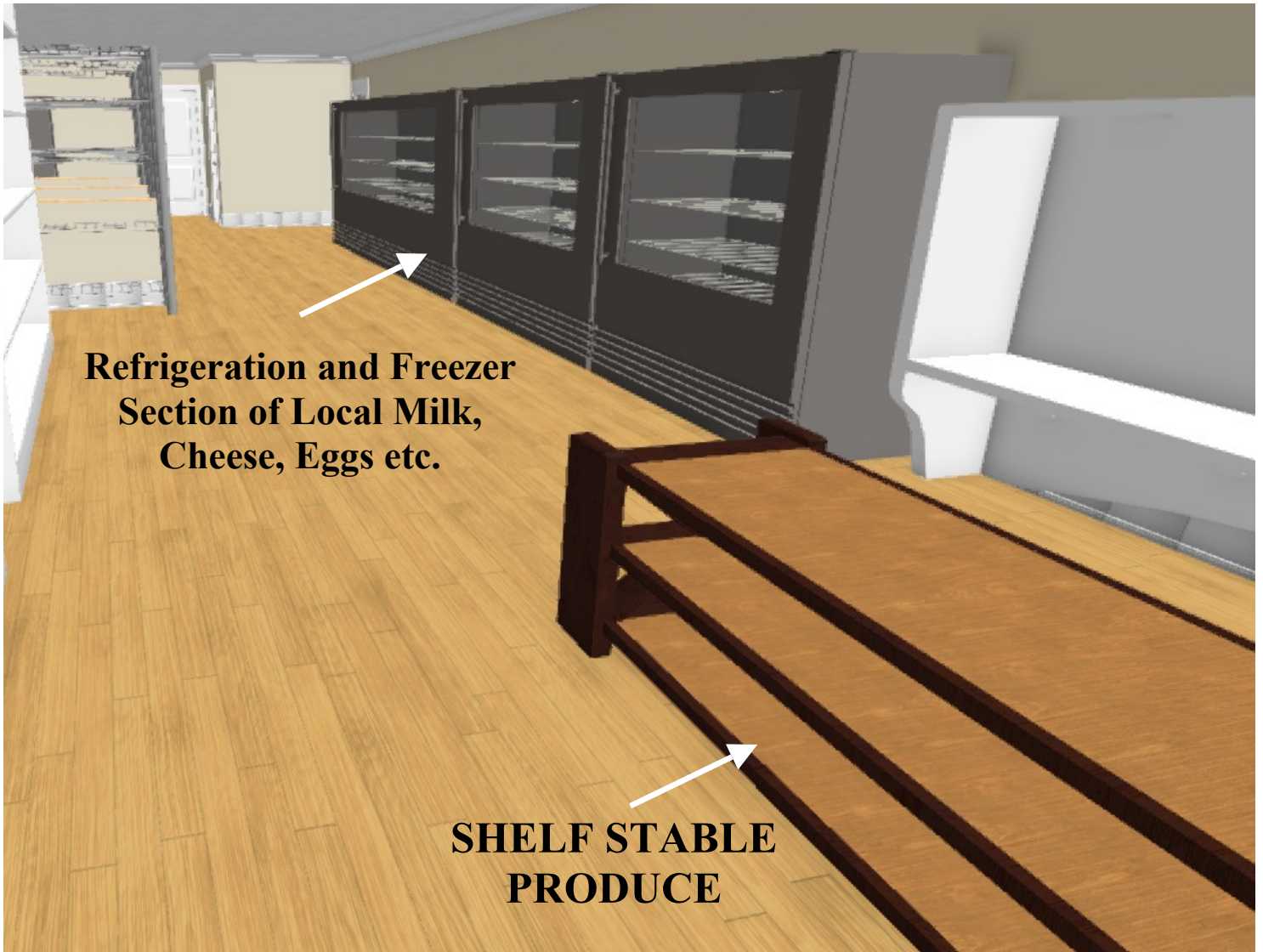

**Refrigeration and Freezer
Section of Local Milk,
Cheese, Eggs etc.**

**SHELF STABLE
PRODUCE**





BATHROOMS

DRY GOODS

LOCAL AND CRAFTED GIFTS



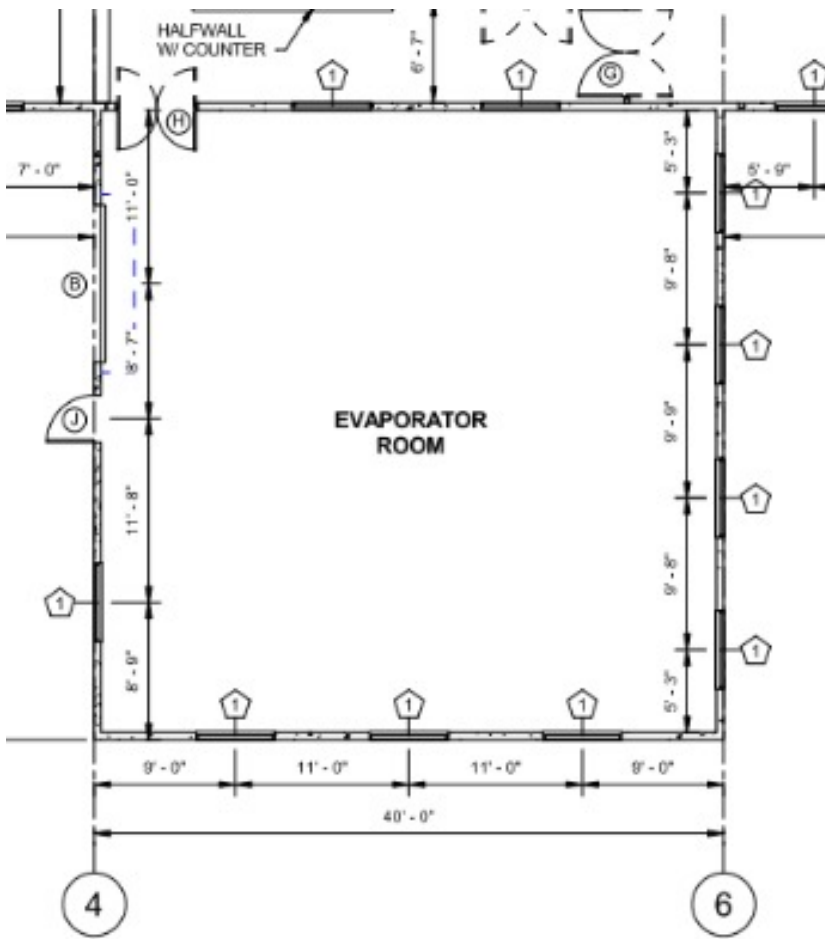

40'x40'
Evaporator Room





CURRENT GIFT SHOP
83 Webster Highway
Temple NH 03084

